

Plywood Sheet #1 Parts Layout

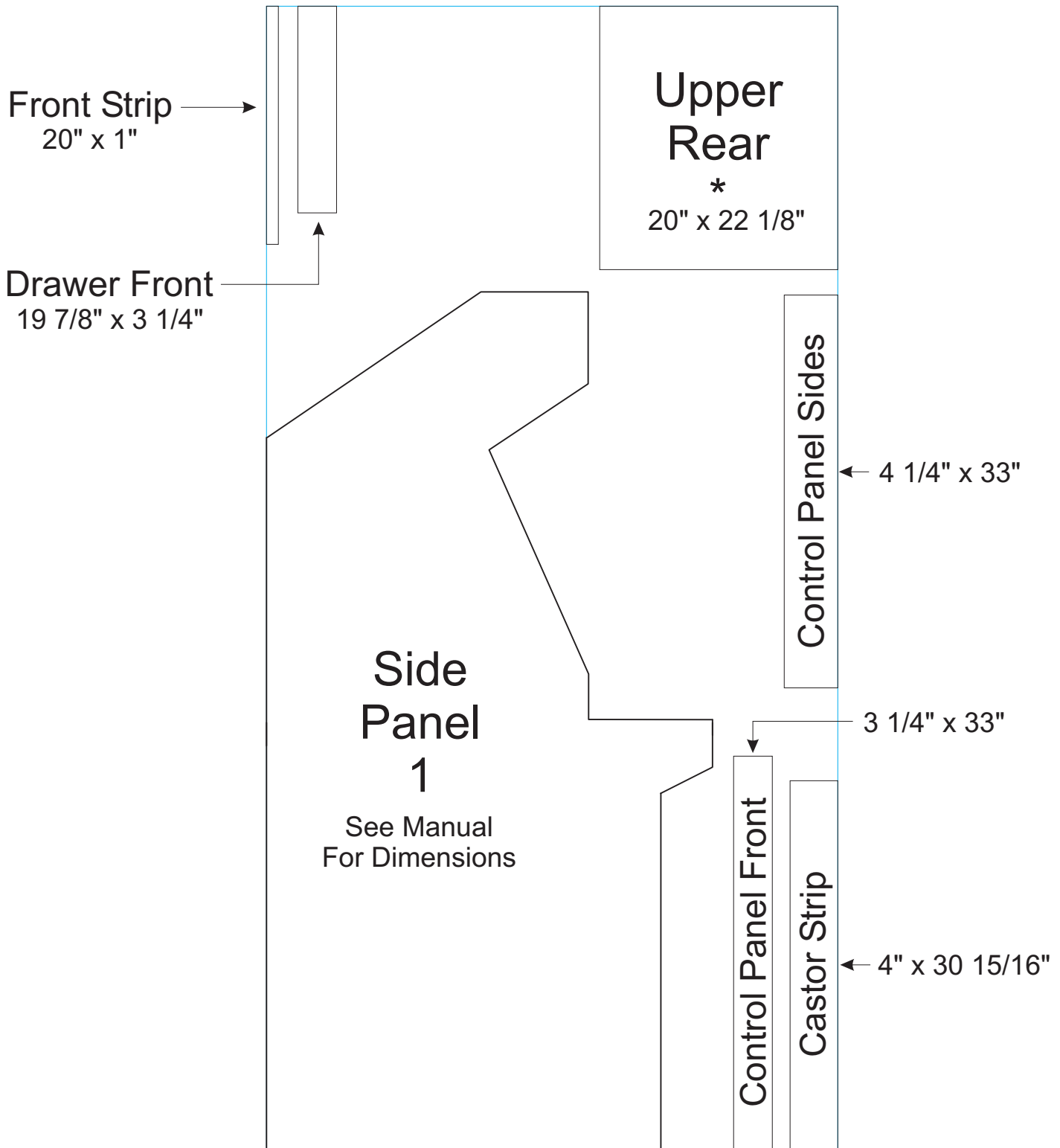

* Cut from sheet 1 only if making a full back panel from page 4

Plywood Sheet #2 Parts Layout

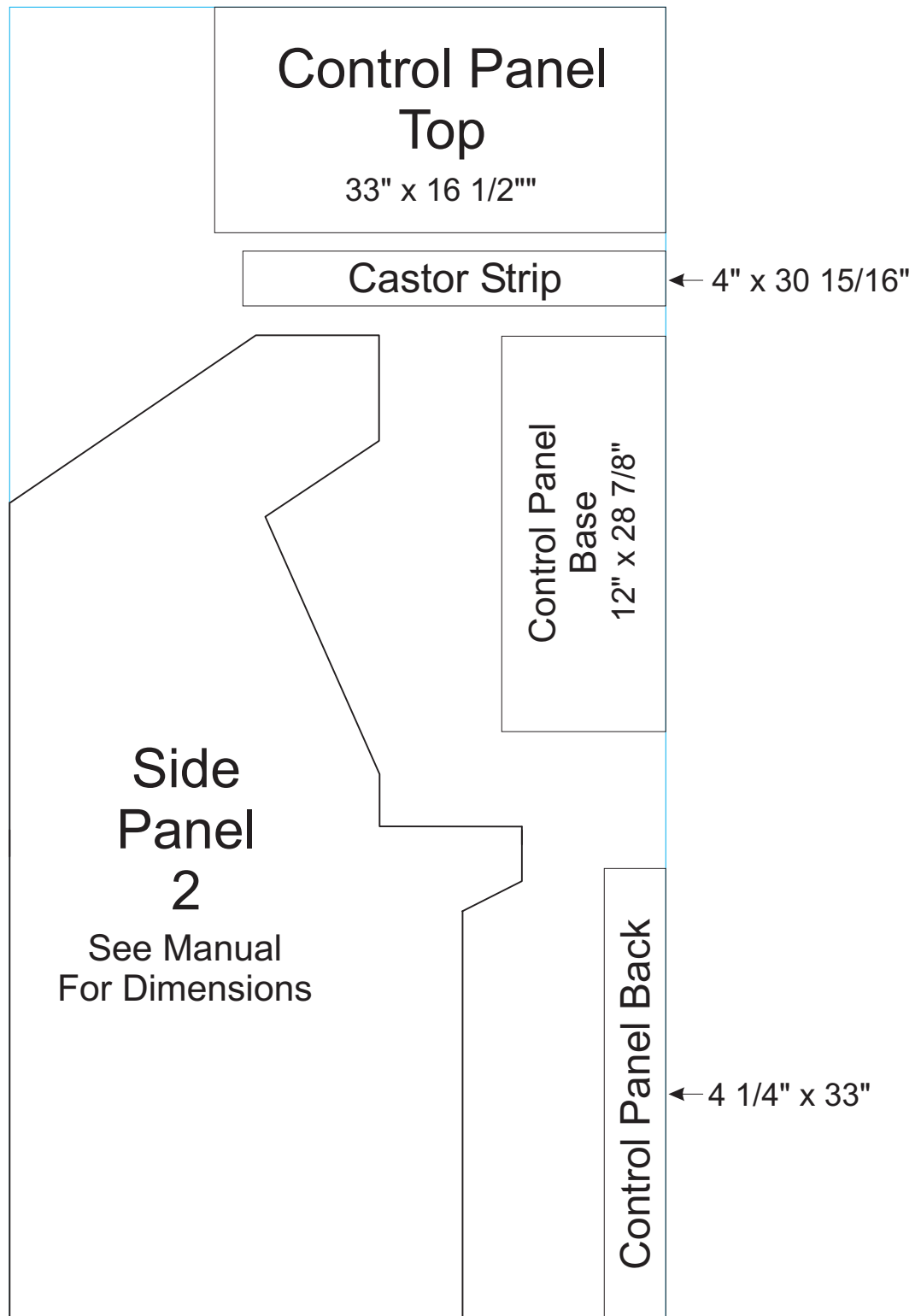

All plywood sheets are 4 x 8 feet when starting
and their outline is indicated in light blue

Plywood Sheet #3 Parts Layout

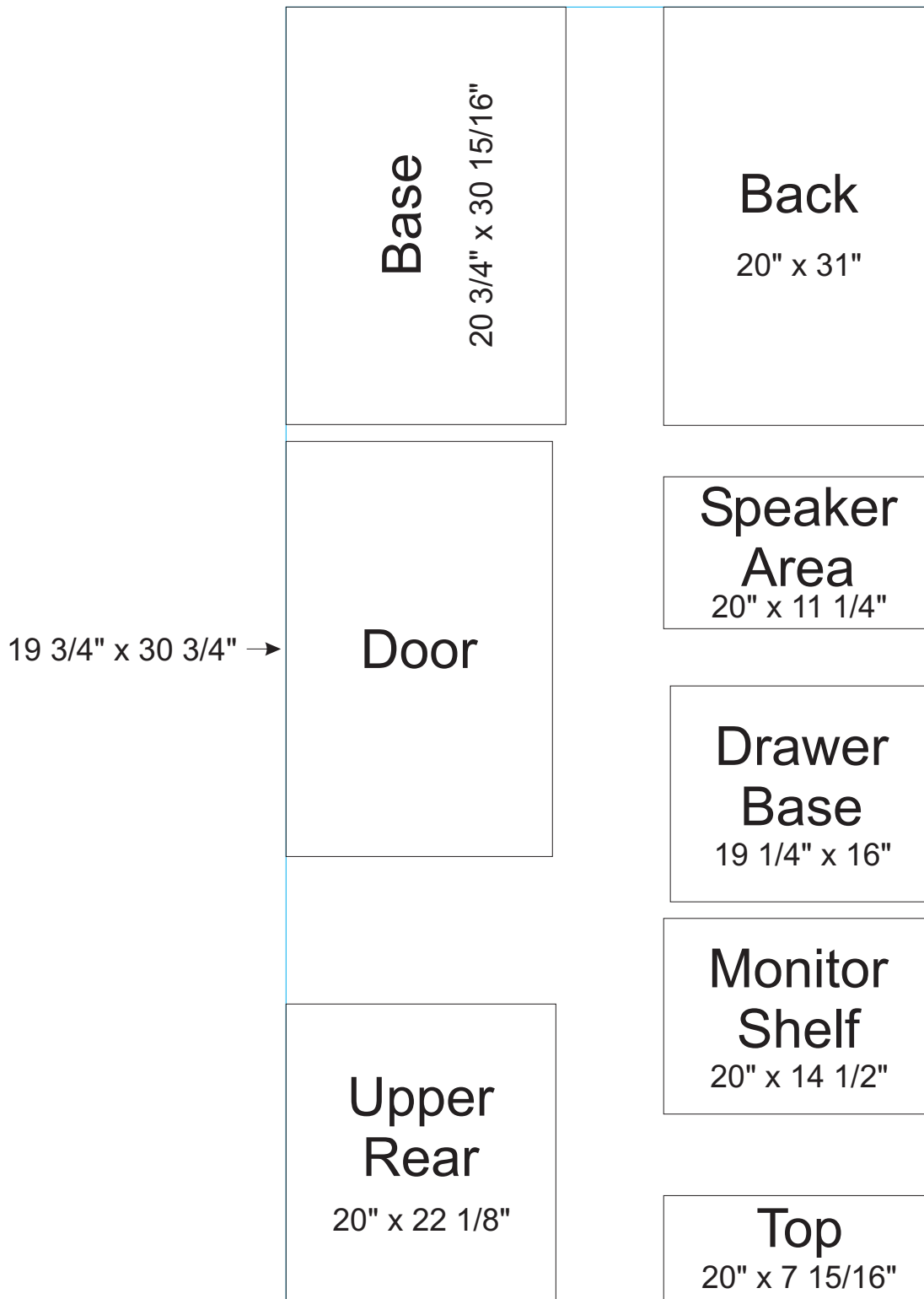

Use this layout for sheet 3 if you are making a partial back cabinet and do not use the cutout for the Upper Rear on sheet 1

Plywood Sheet #3

Parts Layout

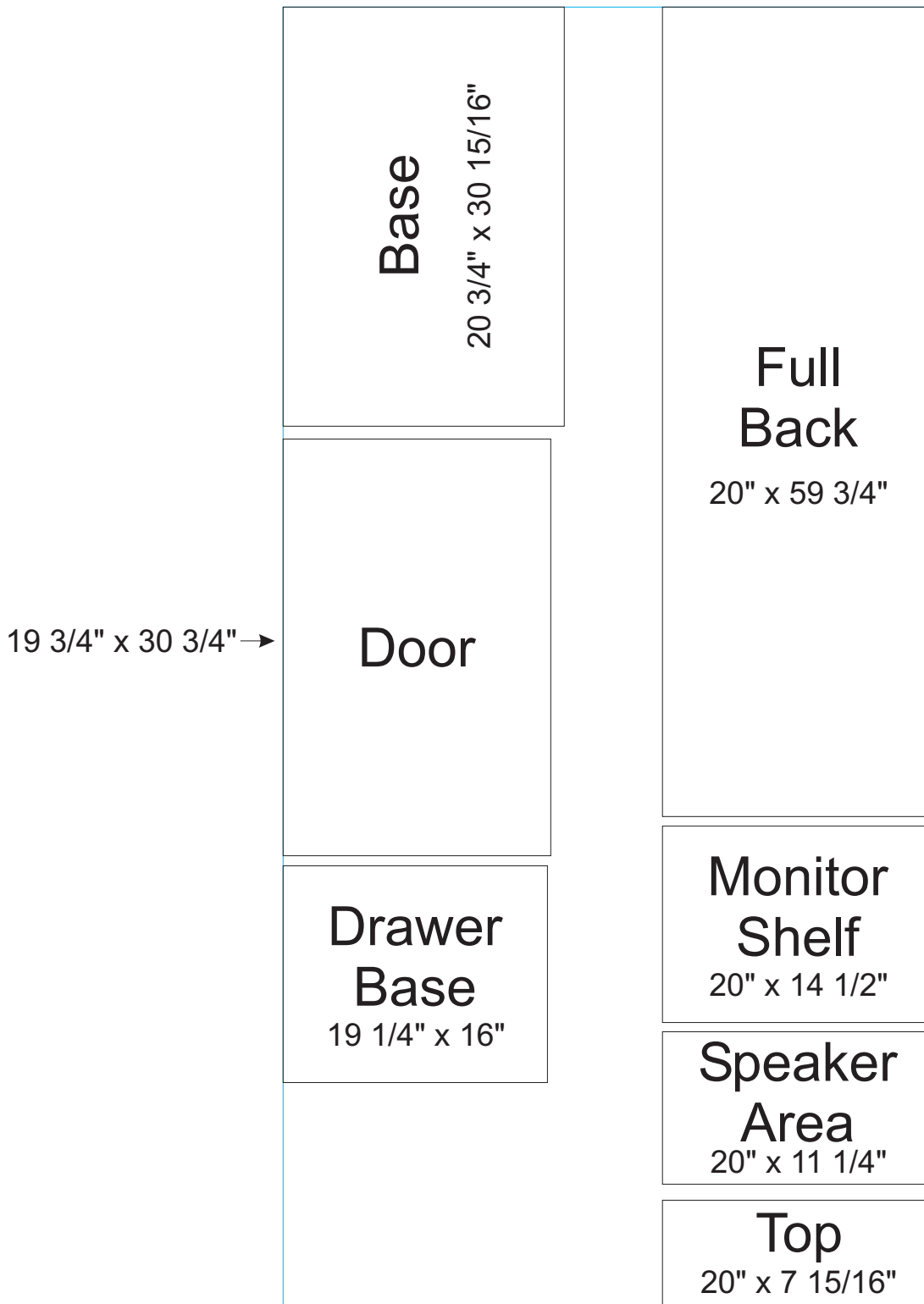

Use this layout for sheet 3 if you are making a full back cabinet and you must use the cutout on page 1 for the Upper Rear panel